

# Gen3™

Gen3 is an architectural-grade, wet-location LED luminaire engineered for the illumination & highlighting of walls & surfaces



## ▶ FEATURES

- Gen3 design allows for any combination of 1, 2, 3 and 4Ft LED modules to be installed for up to 10Ft from a single power feed.
- 1% low-level flicker free dimming.
- Active Thermal Management monitors LED module case temperature and discreetly dims LED module upon signs of possible overheat.
- SmartDriver technology integrated in every LED module, maintaining continuous output regardless of voltage drop, temperature or voltage fluctuations.
- Actively managed ANSI Sub-Binning to ensure accurate and consistent color matching for each LED module.

## ▶ PHYSICAL

- Mil-Spec Anodized Aluminum Housing/UV Resistant Acrylic Lens.
- Weight: 12": 0.7 lb, 18": 0.9 lb, 24": 1.5 lbs, 36": 2.1 lbs, 48": 2.9 lbs.
- Protection Rating: IP66
- Warranty: 3 Years

## ▶ PERFORMANCE

EFFICACY: **80lms/W, 7W/Ft**

POLAR PLOT — 0 Deg. Plane

----- 90 Deg. Plane

**30° Beam Angle**

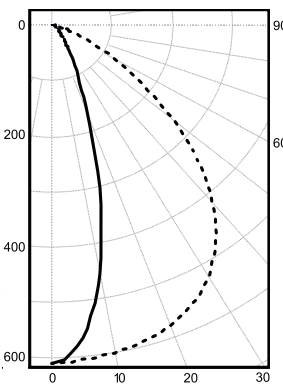

**65° Beam Angle**

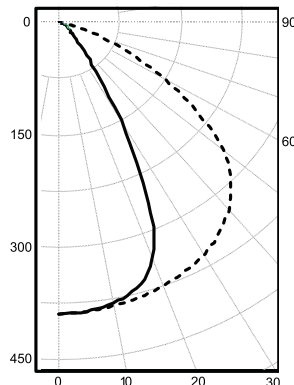

**82° Beam Angle**

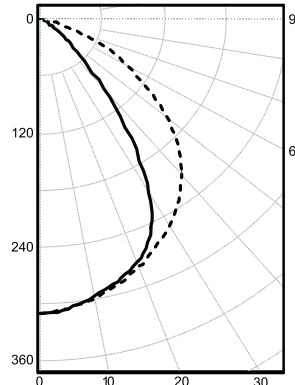

## ▶ SPECIFICATION CODE BUILDER



i2Systems will use specification code and dimensional information below to generate a full BOM that includes all parts needed for a complete installation. **To order replacement parts** refer to page 2 and 3 for a full list of components part codes.

Product	Location	Power	Color	CRI	Beam	Finish	Brackets	Accessories
<b>V3</b>								
	<b>N</b> - Indoor	<b>3W</b> - 3 Watts	<b>20K</b> - 2000K	<b>S</b> - Standard	<b>3</b> - 30° X 65°	<b>B</b> - Black	<b>VLA-14</b> - Adjustable	<b>BB</b> - Baffle Black
	<b>E</b> - Outdoor	<b>4W</b> - 4 Watts	<b>22K</b> - 2200K	<b>H</b> - High	<b>6</b> - 65° X 65°	<b>S</b> - Silver	<b>VLAX2-6</b> - Extend 6"	<b>BC</b> - Baffle Clear Anodize
		<b>5W</b> - 5 Watts	<b>25K</b> - 2500K		<b>8</b> - 82° X 65°		<b>VLAX2-12</b> - Extend 12"	
		<b>6W</b> - 6 Watts	<b>27K</b> - 2700K				<b>VLA-5</b> - Adjustable	
		<b>7W</b> - 7 Watts	<b>30K</b> - 3000K				<b>VLA-15</b> - Fixed	
<b>V3</b> Gen3			<b>35K</b> - 3500K					
			<b>40K</b> - 4000K					
			<b>45K</b> - 4500K					
			<b>50K</b> - 5000K					
			<b>57K</b> - 5700K					
			<b>65K</b> - 6500K					
			<b>C</b> - Custom*					
							<b>Controls</b>	<b>Desired Length</b>
							<input type="text"/>	<input type="text"/>
							<b>SW</b> - Switch On/Off	TO BE FILLED OUT BY
							<b>D1</b> - 0 - 10V Dimming	CONTRACTOR/DISTRIBUTOR

EXAMPLE: V3-N-7W-35K-S-6-B-VLA-14-BB-D1

+Contact factory

## ▶ ELECTRICAL SPECIFICATIONS

<b>Input Voltage</b>	20-30VDC, 24V nom. Use with E05PW 75W
<b>Input Power</b>	3W/Ft - 7W/Ft
<b>Max. Load</b>	10Ft @ 7W/Ft and 25Ft @ 3W/Ft
<b>Max. Wire Distance</b>	50 Ft from Last Light to Power Box using 16 AWG
<b>Temperature</b>	Startup /Operating: -20°C to +40°C Relative Humidity: 0-95% (non-condensing)
<b>Dimming</b>	1% via 0 - 10 VDC
<b>Life</b>	60,000 hours to L70



AMERICAN DESIGNED & MANUFACTURED

# Gen3™

Gen3 is an architectural-grade, wet-location LED luminaire engineered for the illumination & highlighting of walls & surfaces



## ▶ LED MODULE DIMENSIONS

Available in 5 lengths "A" for indoor and outdoor applications:

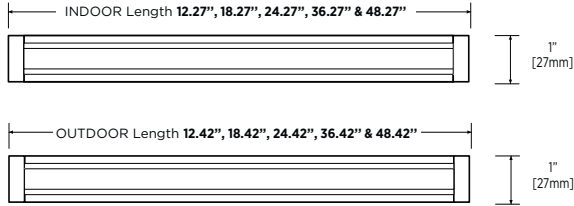

## ▶ LED MODULE PART CODES

Product	Length	Location	Power	Color	CRI	Beam	Finish
V3	12"	x	xW	xxK	x	x	x
V3	18"	x	xW	xxK	x	x	x
V3	24"	x	xW	xxK	x	x	x
V3	36"	x	xW	xxK	x	x	x
V3	48"	x	xW	xxK	x	x	x

## ▶ DIMMING CONTROL

LightLink \_\_\_LL-205-10V

Indoor Dimming Cable:  685-01561-100  
Outdoor Dimming Cable:  685-02026-100

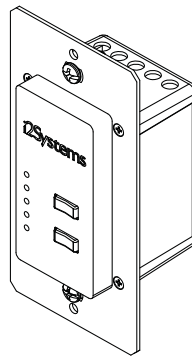

## ▶ POWER BOXES

75W Power Box\*:  E05PW 75W

\*Powers up to 10 Ft of Gen3

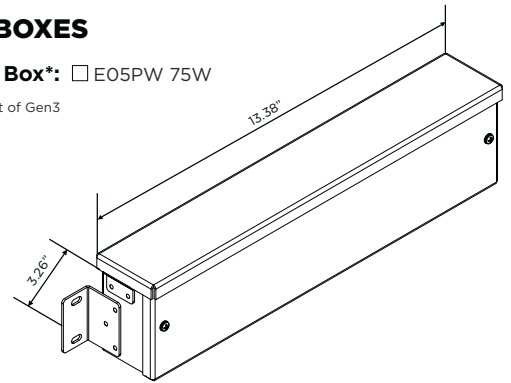

## ▶ OPTICAL ACCESSORY

Baffle:  810-50956-XX

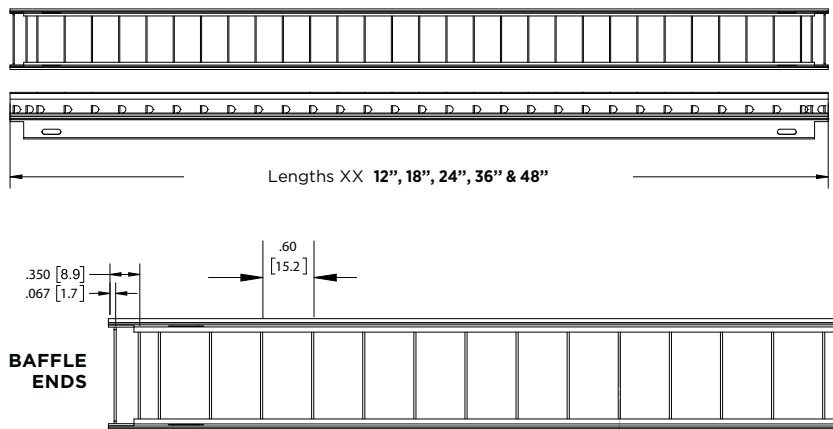
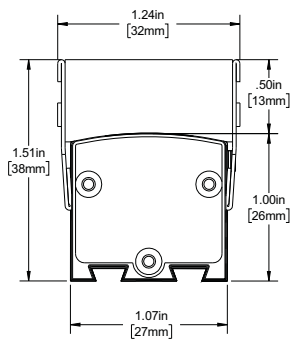

## ▶ BRACKETS

Adjustable \_\_\_VLA-5

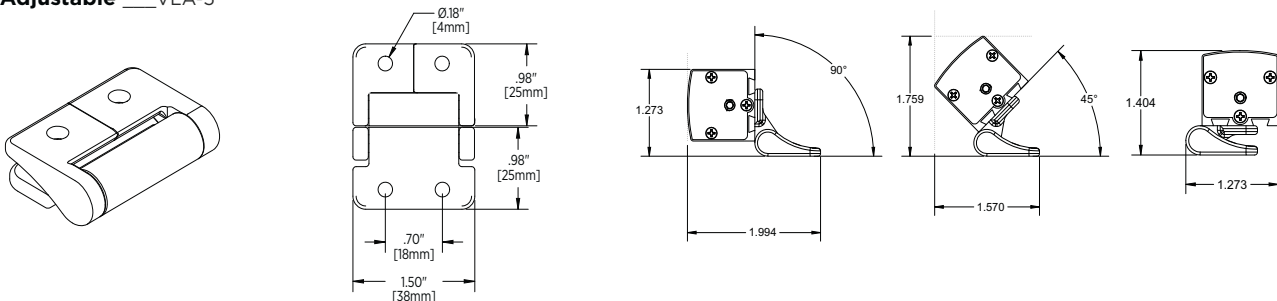

# Gen3™

Gen3 is an architectural-grade, wet-location LED luminaire engineered for the illumination & highlighting of walls & surfaces



## ► BRACKETS

### Adjustable \_\_\_VLA-14

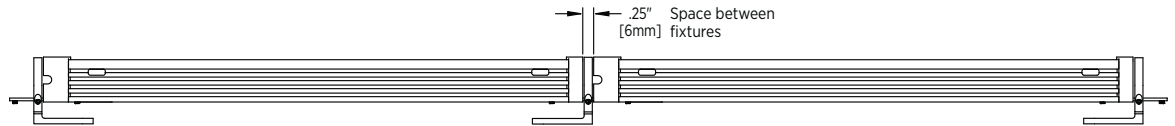
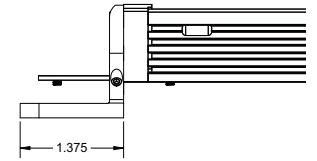
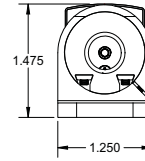
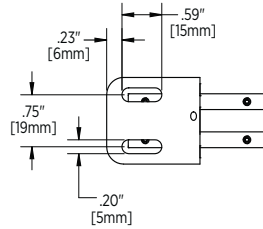
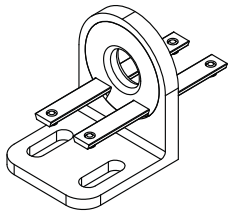

### Fixed \_\_\_VLA-15

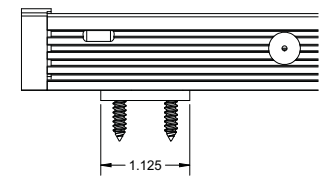
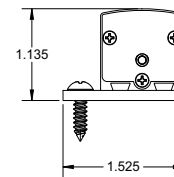
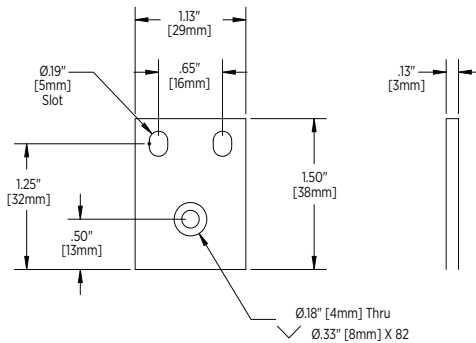
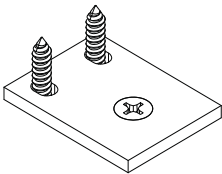

### Adjustable Extension Mounting Clip \_\_\_VLAX2-6 \_\_\_VLAX2-12

