



S-Line S1180

PATENTS
PENDING

LED Linear Light

PRODUCT BEING REPLACED
Refer to S-Line S1200 or S2190 for new designs

PRODUCT HIGHLIGHTS

- 5 Watts / Ft. (Average)
- 24V DC Input
- 0 to 100% Dimming
- 12", 18", 24", 36", 48" Lengths
- 30°, 65°, 82° Emitting Angles
- Polycarbonate Optic
- Flexible Mounting Options

TYPICAL APPLICATIONS

- Refrigeration Lighting
- Display Case Lighting
- Retail Shelf Lighting
- Under Shelf / Under Cabinet

SPECIFICATIONS

SUITABLE ENVIRONMENTS



Dry Damp

LED COLORS

- Cool White
- Neutral White
- Warm White
- Green
- Blue
- Red

FINISH



Black

LENGTHS



BEAM ANGLES



CERTIFICATIONS



Features

■ ADVANCED OPTICAL SYSTEM

Three emitting angle options for precise light. Wide lateral distribution and advanced optical design provide uniform light distribution.

■ 0 TO 100% DIMMING

Connection with i2Systems LightLink Series allows simple and seamless integration to most of today's conventional dimming systems.

■ RUGGED DESIGN

Impact resistant polycarbonate optic / housing and anodized aluminum construction ensure product longevity.

■ NO HEAT OR UV IN THE LIGHT BEAM

With no heat in the light beam, the fixture lens remains much cooler than halogen sources, allowing safe and 'burn free' operation. In addition, no UV means reduced risk of fading or deteriorating products or artifacts on display.

■ FLEXIBLE MOUNTING OPTIONS

Stainless Steel brackets are available in adjustable or fixed options. Snap on design allows installation to any position along the fixture.

Exclusive Technology

■ ACCUWHITE™

i2Systems AccuWhite technology allows integration of S-Line fixtures to traditional applications without sacrifice in color temperature (CCT) or color rendering (CRI). AccuWhite ensures accurate and consistent color matching from fixture to fixture and across product lines.

■ LIGHTLINK™ COMPATIBLE

i2Systems LightLink controllers represent the next generation in lighting control and connectivity. LightLink modules provide seamless integration of today's commercial and residential dimming systems through a wide variety of desirable interfaces.

SPECIFICATIONS

ITEM	PARAMETER	VALUE
Electrical	Input Power	12" = 7.5W / 18" = 7.5W / 24" = 15W / 36" = 15W / 48" = 22.5W
	Input Voltage Range	23-25V DC
	0-100% Dimming	✓
	Protection Features	Transient Protection, Reverse Polarity, Autoreset Fuse
Optical	Emitting Angle	30°, 65°, 82°
	LED Color	Cool White, Neutral White, Warm White, Green, Blue, Red
	LED Colors per Fixture	1
	Class	Class 2 LED Product
Physical	Dimensions	Refer to drawings on right
	Housing Construction	Aluminum
	Lens Material	Polycarbonate
	Lengths	12", 18", 24", 36", 48"
	Finishes	Black
	Mounting Method	Snap, End or Dovetail
	Operating Temp. Range	-20°C to 30°C, Max. Case Temp (Tc): 50°C
	Humidity	0 to 95%, non-condensing
	Environment	Dry, Damp
	Certification	FCC Part 15, Class B, ETL (US & Canada), RoHS Compliant

DIMENSIONS

Lengths

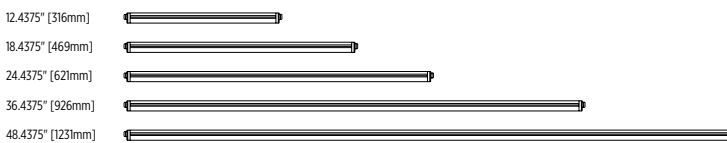

End

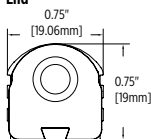

WIRE FUNCTION

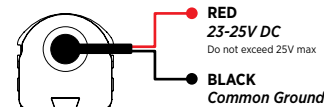

MOUNTING

SLA-1: Adjustable Mounting Bracket

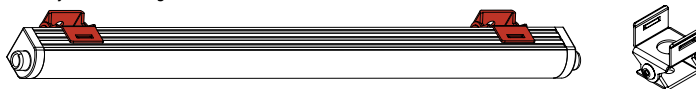

SLA-2: Fixed Mounting Bracket

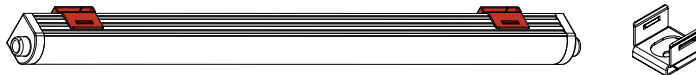

SLA-3: Pivot Mounting Bracket



ACCESSORIES

KEYWORD	ITEM NUMBER	DESCRIPTION	FIXTURE MAX
Adjustable Mounting Bracket	SLA-1	Stainless Steel Adjustable Mounting Bracket w/ Stainless Steel Mounting Screw, Snap On Installation to Fixture Housing.	
Fixed Mounting Bracket	SLA-2	Stainless Steel Fixed Mounting Bracket w/ Stainless Steel Mounting Screw, Snap On Installation to Fixture Housing.	
Pivot Mounting Bracket	SLA-3	Stainless Steel Mounting bracket w/ Stainless Steel Mounting Screw, End Mount and Pivot Rotation.	
LightLink LL-105	LL-105 Series	Dimming Controller, Multiple Interfaces including 0 to 10V Control.	Dims up to 6 Feet S-Line S1180
LightLink LL-205	LL-205 Series	Dimming Controller, Multiple Interfaces including 0 to 10V Control.	Dims up to 18 Feet S-Line S1180
45W Power Supply Enclosure	PS24V45W-E01D	Power Supply Enclosure, 45W, 120/240VAC Input, 24VDC Output, Steel Enclosure w/ Knockouts & Terminal Blocks.	Powers up to 6 Feet of S1180
75W Power Supply Enclosure	PS24V75W-E01D	Power Supply Enclosure, 75W, 120/240VAC Input, 24VDC Output, Steel Enclosure w/ Knockouts & Terminal Blocks.	Powers up to 10 Feet of S1180
25W OEM Power Supply	PS24V25W-01	Power Supply, 25W, 120VAC Input, 24VDC Output	Powers up to 2 Feet of S1180
40W OEM Power Supply	PS24V40W-01	Power Supply, 40W, 120VAC Input, 24VDC Output	Powers up to 4 Feet of S1180
100W OEM Power Supply	PS24V100W-01	Power Supply, 100W, 120/240VAC Input, 24VDC Output	Powers up to 10 Feet of S1180

INSTALLATION EXAMPLE

Display Lighting

EXAMPLE:
Shown with 0 to 10V Dimming via LL-105-R.

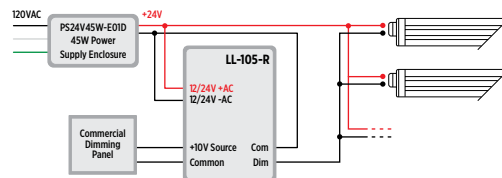

ORDERING NUMBER

FIXED FACTORY NUMBER

EXAMPLE: **SL1-265-2**

USER SELECTED OPTION

24" Length, 65 Degree Beam Angle, Warm White LED

SL1 - **X** **Y** - **Z**

Length

- 1 - 12"
- 8 - 18"
- 2 - 24"
- 3 - 36"
- 4 - 48"

Beam Angle

- 30 - 30°
- 65 - 65°
- 82 - 82°

LED Color

- 1 Cool White
- 12 Neutral White
- 2 Warm White
- 3 Green
- 4 Blue
- 7 Red